

Intersection

August 2010



PAM
Pertubuhan Akitek
Malaysia
Sarawak Chapter

For Members Only

PAMSC Quarterly Newsletter No. 04/2010

www.pamsc.org.my



DATUM KL 2010

...more on page 9

FEATURE ARTICLE CONTENTS



BORNEO CONVENTION
CENTRE KUCHING

P4



WEBSITE LAUNCH

P6



BTS 2011 LAUNCH

P7



INTERVIEW WITH MIN

P8



QUICK TIPS ON VISITING
THE SHANGHAI EXPO 2010

P14

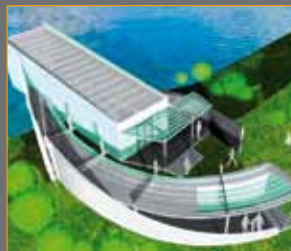

THREE AMIGOS

P22

CONTENTS

PAMSC ANNUAL
GENERAL MEETING

P11

PAM & HABITAT
FOR HUMANITY

P12

SHANGHAI GOOD EATS

P15

POST SHANGHAI NITE

P16

DRAWING CONTEST FOR
SECONDARY SCHOOL

P18

SKETCHING WITH PURPOSE

P21

RECENT SEMINARS
AT PAMSC

P23



The current term of PAMSC Committee 2009-2010 comes to an end in July 2010; as such this is the 4th and last issue of **INTERSECTION** for this term. I am pleased to note that the support from fellow architects and building trade advertisers for our newsletter is growing from strength to strength. On that note, I would like to express my thanks and appreciation to our Publication Sub-committee led by Ar. Ivy Jong and assisted by Ar. Wee Hii Min; for their tireless contribution and dedication which has resulted in the success of **INTERSECTION** during this term.

PAM Convention 2010 which was held from 1st to 4th July 2010 at Kuala Lumpur Convention Centre (KLCC) was another successful event not only for PAM, but also for the building and construction industry in Malaysia. This DATUM KL 2010 recorded 2500 participants with no less than 200 participants from Sarawak, PAM also registered 1000 participants each for both Kuala Lumpur Design Forum and Green Building Forum.

PAMSC would also like to acknowledge that our PAMSC member, Ar. Wee Hii Min from Design Network Architects (DNA) was invited as one of the ten speakers for DATUM KL 2010.

The 35th PAMSC AGM will be held on Saturday 31st July 2010 at PAMSC Centre; PAMSC members are encouraged to attend. The Notice and Nomination Form for the AGM have been sent to all members.

This is my first term as the chairman of PAM Sarawak Chapter for year 2009-2010 and it has been very challenging yet enjoyable term; and a BIG thank-you to the committee where everyone has unselfishly contributed their valuable time and effort towards the Institute.

My best wishes,

Ar Desmond Kuek
Chairman
PAMSC



WE WOULD VERY MUCH LIKE TO INTRODUCE.....

Ms. Melinda Leong and Puan Nur Farisha Bt Junaidi (better known as Sasha) of PAMSC. Our ever helpful and friendly support at PAMSC.

Sasha joined the team in April 2010, we would like to say a big welcome ! Finally Melinda has an extra pair of hands, and company at the PAMSC !

With this new team, the office hours of PAMSC is now extended as follows:
**8.00 a.m. to 12.30 p.m. and
2.00 p.m. to 5.00 p.m. (Mon-Fri).**

So, a note of thanks and appreciation to our fabulous ladies at the desk for ensuring that the centre runs smoothly, especially for the extra time they put in during seminars, talks, get-togethers and meetings at the centre that are held after office hours and during the weekends for members conveniences.

Thank you ladies!!

Please contact the secretariat at **082-457189 (Melinda)** or **mail:pamscintersection@gmail.com** should you wish to contribute.

EDITORIAL



We are very happy to be presenting our 4th Issue of **INTERSECTION** for the term **2009-2010**. This issue is a 'bumper crop' because there are so much notable achievements made within the last 2 months. It will also be a foretaste of what is in store for 2011 which as you may be aware of, a 'Building Trade Show' year.

The launching of BTS 2011 on the 30th July 2010 is featured in this issue. Every two years, the building trade show is organized with major efforts from all quarters; it is one of the main income generator for our chapter. The income garnered goes toward supporting our chapter's numerous activities held throughout the next 2 years.

We have also launched our PAMSC website that day. Yes ! PAMSC is 'coming of age' as we will now be more 'accessible' than before. With this, our members from near and far can access PAMSC news, activities and resources from the comfort of their PC, be it at home or at work. It is also hope that vice-versa; our members will take this opportunity to give PAMSC feedbacks and contributions to make PAMSC a relevant centre for her members.

We are also proud to feature our very own Ar. Wee Hii Min. He is one of the invited speakers to DATUM KL 2010 in July. We congratulate DNA on this. **INTERSECTION** considers it befitting to feature him and his firm Design Networks Architects as they have made foot holds not only locally but internationally with their architectural works. This we hope, will be an inspiration for our fellow architects to pursue excellence in architecture not only within Sarawak but across the waters.

It is also apt that the building featured in this issue is the Borneo Convention Centre Kuching. Our Building Trade Show 2011 will be held there in March 2011. We very much like to thank Ar. Stephen Mong for his contribution on this.

Last but not least, we would like to thank you for your support and encouragement for the term. We hope that more members will come forth to assist and contribute in many areas within the chapter and PAMSC can stand tall and have a louder voice for architects practicing in Sarawak.

Ar. Ivy Jong
Editor



Certification No. 032-065

OUR PAINTS COME IN THOUSANDS OF COLOURS. BUT THE ONE WE'RE MOST INTERESTED IN IS GREEN.

Nature is the mother of all colours. We, at Nippon Paint, dedicate our best efforts to protect and preserve mother nature for the benefit of our future generations. We reduce energy consumption and minimise water disposal. We also developed ultra low VOC and energy saving products. As one of the leading paint manufacturers, we remain firmly committed to a better, brighter and cleaner future for the planet.
Contact us and let us show you more reasons why we are the paint experts.

Agent:

成利玻璃有限公司
SENG LEE GLASS SDN. BHD. (387670-T)

Lot 9575, Jalan Pending, 93450 Kuching, Sarawak, Malaysia.

Tel: +6 (082) 337733 Fax: +6 (082) 332255

Email: info@sengleeglass.com

www.sengleeglass.com

SAINT-GOBAIN
GLASS

World Leader in Glass Manufacturer

Glass for the architecture of today and tomorrow

SGG COOL-LITE® SKN

Solar Control & Low-E high performance coated glass

SGG COOL-LITE SKN®

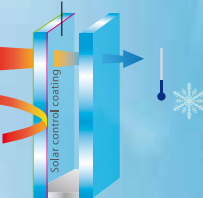

SGG COOL-LITE® ST

Versatile solar control glass that can be tempered and curved

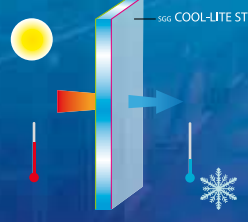

SGG BIOCLEAN®

Low maintenance photo-catalytic glass

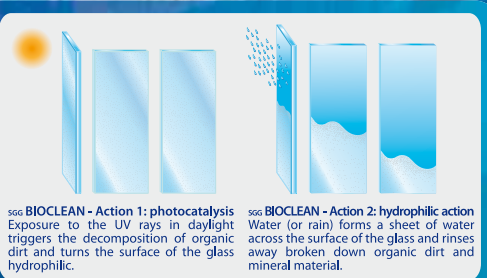

SGG BIOCLEAN - Action 1: photocatalysis
Exposure to the UV rays in daylight triggers the decomposition of organic dirt and turns the surface of the glass hydrophilic.

SGG BIOCLEAN - Action 2: hydrophilic action
Water (or rain) forms a sheet of water across the surface of the glass and rinses away broken down organic dirt and mineral material.

SGG SERALIT®

Screen-printed toughened glass





Aerial view

BORNEO CONVENTION CENTRE KUCHING

The inception for this project was in 2003 when it was mooted that Kuching needs a convention centre to be a serious contender in the MICE (Meetings, Incentives, Conventions and Exhibitions) industry. Subsequently, a feasibility study was conducted together with several visits to convention centres around the region.

On 21 April 2006, the JKR Sarawak issued a Letter of Acceptance to PPES Works; with a commencement date on 5 May 2006.

Laying The Groundwork

At the very early stage, it was identified that many other agencies and facilities had to be in place or upgraded for the Convention Centre to succeed.

One of the agencies to be established was a convention bureau, tasked with the promotion of the State as a destination for MICE. The Sarawak Convention Bureau (SCB) was then established and entrusted with this task. It is often a misconception that SCB works for BCCK alone, as this is not the case.

The other critical item for the establishment of the BCCK was an operator for the facility, much like a hotel has an operator. This was not in place until nearly a year into construction; which resulted in changes and variations to the contract. In the absence of an operator, a consultant operator was engaged to do an operational review in 2007 with the aim of pre-empting any issues, which may crop up later when the operator was on board.

"Let's Meet Under The Trees"

The lush rainforest was the inspiration for the form of the building. Several options were explored by Arkitek KDI; the architectural consultant for the



project - including a version which had the roof composed of many smaller canopies (similar to the Esplanade in Singapore, but on a larger scale).

The design finally chosen was a simple single leaf form and this was the version that was finally built. The leaf was described as the "daun ririg" - a common leaf used to wrap food by our local people.

Orientation

Several passive design features were incorporated in the design of the BCCK; which included the orientating the elliptical floor plan along the east-west axis (hence the longer elevation faced north-south). This orientation also allows the prayer rooms, located at one tip of the ellipse; to face Qiblat.

Stature

The decision to have the main activity area for conventions & meeting rooms at Level 2 was to achieve a certain stature and afford views to the Sarawak River.



Great Hall A



Great Hall A + D



Great Hall A + B + C + D



Aerial view



Main concourse - night view



External front view from riverfront



Side concourse

Level 1 was designed with a 5 metre floor to floor height – to cater for temporary exhibitions and other such activities; and to allow for the future expansion of the convention centre should the need arise.

This proved to be a decision well made as the latest PBB Convention saw the operator utilizing the carpark at Level 1 as a delegates’ dining area.

Insulation

The design of the building took into account thermal and acoustic insulation for the function rooms and the public concourse area.

A large air gap located below the main canopy roof and above the meeting rooms provided the thermal insulation and acoustic separation from the roof.

The build up of the roof was specially designed with an acoustic consultant to further ensure that the main hall could achieve the desired STC (sound transmission coefficient) which is successful in eliminating noise as one could hardly notice the sound of heavy rain when in the Great Hall.

There was much debate with JKR Sarawak on the large glass façade of the entrance and the heat gain through this elevation. The consideration to go for low-E glass or double glazing was considered but exceeded the budget, the architect then provided an analysis and simulation of the shading afforded by the roof overhang and entrance canopies. This indicated that much of the solar penetration occurred in the ‘landas’ season in Kuching, and the matter was put to rest.

Internal Finishing

It was recommended that the internal finishing of the function rooms should be kept simple and clean to enable the operator to decorate and change the mood of the rooms to suit the function. The jungle concept carried through into the modern internal finishing in the use of timber finishes, groove lines on walls reminiscent of jungle vines, and carpet simulating the jungle floor.

Construction

The execution of the contract was packaged into over 30 works and supply sub-contracts, which translated into many coordination meetings and interfacing works by the main contractor. When it became apparent that the project would be delayed due to late sub-contract works, remedial actions were taken with the replacement of the late sub contractors. The implementation of double shift or night work was not effective due to the local workforces’ unwillingness to do overtime; compounded by competition for workers in the local market (as at the time, the DUN, Pullman Hotel and Four Points Hotel were at various stages of construction) also became a factor and impacted on the cost.

Post Handover

In the initial feasibility study, it was anticipated that in the first year of operation, there could be 50 local events and 8 international functions. The BCCK has far exceeded this target.

The consultant operator had remarked that in all convention centres that they have been involved in; upon the opening of the facility, the operators are already looking at expansion due to the amount of business they generate.

It is our hope that the BCCK ‘suffers’ this same fate.

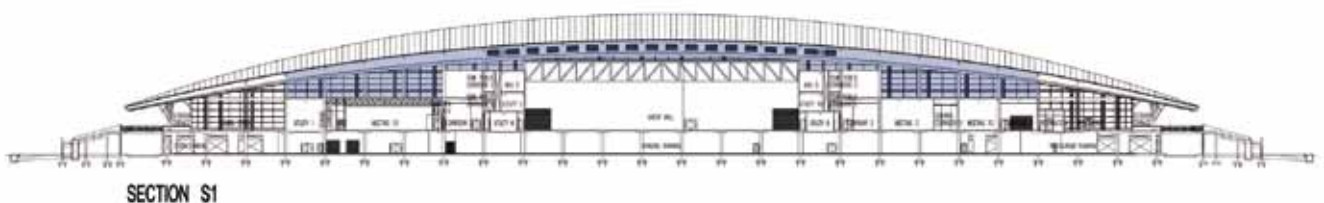

SECTION S1



SECTION S2



WEBSITE LAUNCH

Our Chairman, Ar. Desmond Kuek; Deputy Chairman, Ar. Mike Boon; Vice Chairman, Ar. Peter Wong and Immediate Past Chairman, Ar. Ng Chee Wee did the honours of kicking off the web portal.

The ALL NEW, PAMSC website (www.pamsc.org.my)

The PAMSC web portal was officially launched on Friday 30th July 2010. The launch event was held alongside the BTS Launching at "Backstage" (The Junk) in Kuching and was attended by the PAMSC Committee, various guest and participants of BTS. Our Chairman, Ar. Desmond Kuek; Deputy Chairman, Ar. Mike Boon; Vice Chairman, Ar. Peter Wong and Immediate Past Chairman, Ar. Ng Chee Wee did the honours of kicking off the web portal.

With the motto "One Site to Find Them All", the PAMSC web portal is meant as a one stop for news, announcements, CPD registration, resources and more. It is the goal of PAMSC that the portal will be the main information/announcement broadcast channel for its members and the architect community in general. Fellow members can make use of the portal to search for relevant information, articles and ideas as the news section will be updated frequently.

Another exciting feature of the portal when fully implemented is the ability to search for suppliers and manufacturers of building products and materials in a supplier's directory.

As a service to the general public, the new portal will also make the search for architects a lot more user friendly. Each architect will be setup with an architect profile page, where contact information and other relevant information will be made available for the public. The members have the flexibility to update their own profile easily as with social networking sites so that information can be kept current; with just the username and password. To activate the profile page, please contact the secretariat with a VALID AND ACTIVE PERSONAL email so that the new system can be initiated properly.

The new portal will be managed by Madtech Online Marketing (www.madtech.com.my), a professional web marketing, development & management firm based in Kuching. All technical feedback and enquiries can be addressed to Madtech Online Marketing via email at support.pamsc@madtech.com.my, with a CC to the secretariat for further action.

PAMSC looks forward to members participating in our very own portal !



Introductory multimedia presentation during the launch to outline the features of the new portal.



Suppliers and fellow members looked on during the brief but informative 2 minute multimedia presentation.



Ar. Kevin Wong (PAMSC It Chairman) looking on to the new website with Members of PAMSC and Mr. Frederick Ho, event manager for BTS 2011.



BTS 2011 LAUNCH



The organising committee - our poster boys for BTS 2011, Mr. Kevin Phua and Ar. Ken Chan.

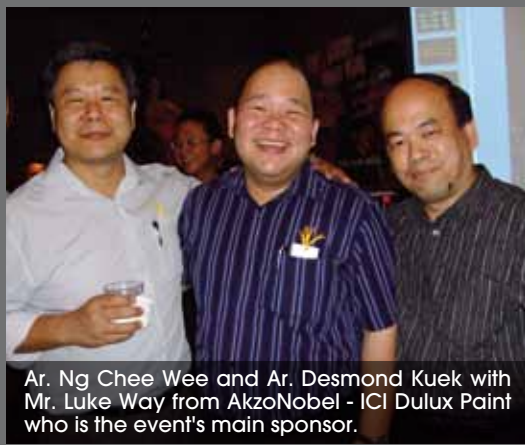

Ar. Ng Chee Wee and Ar. Desmond Kuek with Mr. Luke Way from AkzoNobel - ICI Dulux Paint who is the event's main sponsor.



Gentlemen having a laugh at the launch.

BTS 2011 was successfully launched at "Backstage" (The Junk Restaurant, Kuching) on the 30th July 2010. A fun filled Friday afternoon where industry suppliers, manufacturers, builders and planners came together to celebrate with fellow PAMSC architects on the launch of BTS 2011 which will be held between 24 to 27 March 2011 at Borneo Convention Centre Kuching.

It was a successful afternoon with well over 50 booths confirmed for the event. It promises to be the biggest show of its kind in Borneo. The launch was jointly officiated by representative from CIDB and PAMSC.

The organising committee comprises of Ar. Kevin Phua and Ar. Ken Chan is chaired by Ar. Mike Boon.

The event management assisting is Techno Expo Systems (M) Sdn. Bhd headed by Mr. Frederick Ho.

The event was concluded by a lucky draw with much merriment to be had by all.



Industry suppliers studying the selection of booths available to book for BTS 2011.



Yam Seng !



Hock Peng Realty - winner of the lucky draw.

INTERVIEW WITH MIN



I: You were invited to be a speaker at DATUM KL this year. This should be taken as acknowledgement from your peers in Malaysia of the excellence of DNA's work. We congratulate you and DNA! What are your thoughts on this?

M: We are a young practice so any form of recognition from our peers is a BIG deal - be it in publications, awards or an invitation to speak. It signals to our young partners and designers that their work has significance in the profession; this is especially important because we are in Sarawak. People who live on islands can sometimes feel isolated and forgotten.

I: You spoke at ARCASIA Congress 2007 in Sri Lanka to an audience of about 3,000. Is there any difference speaking to a 'home crowd' of similar capacity at DATUM this year?

M: Yes, with three years under our belt - I felt that more was expected from us. Speaking locally requires more relevance because the audience knows our work. There is a greater responsibility both to the office and to Sarawakian architects to present well at DATUM. It is a significant forum - you cannot waste the opportunity with a mediocre presentation. Also - Sri Lanka was 25 minutes, DATUM was 45; but it was alright - we have accumulated more work in the past three years.

I: If you weren't an architect, what would you have liked to be?

M: A jazz pianist like Harry Cornick Jr. But more realistically - a chef. Or travel writer or maybe just a writer.

I: You have been attending DATUM over the years. Obviously been a speaker this year would provide a different perspective on things. What was the highlight for you at DATUM this year?

M: Not having to fly budget and stay at the Tune Hotel; but to fly MAS and stay at the Traders Hotel for 4 days.

I: And as speaker representing DNA.

M: Being invited to speak was the highlight for me; equally amounts of pleasure and pressure (I was preparing the talk for two weeks from 4 to 8 a.m. till the day of the talk). My partners were under a lot of pressure as well because I did not give them a preview; they saw it for the first time with everyone else.

I: Having co-founded DNA in 2000, it has been a ten year journey for you and your partners, Hwong How Hing, Wong Kiong and William Khoo. How do you and your partners see DNA in the next 10 years?

M: We believe in the grooming of new people to take over our roles. Earlier this year, we recruited 4 young partners who will continue the company's work - and hopefully build something significant outside Sarawak within the next five years.

I: And what has been most memorable experience for you the past ten years?

M: Visiting Geoffrey Bawa's Lunuganga in Sri Lanka and recently, moving into our own office; my present studio fits my mental image of an ideal work space.

I: What are your favourite hobbies/pastime?

M: Designing things and getting them built, travelling and sketching what I see, running and swimming, cooking for friends and playing the piano.

Thank you



Wongkiong, William, Arlene, Ipod, Leong, Hwong, Suhchee, Min, Mingi



Rock Road show room - we wanted a building that demonstrated permanence and solidity in keeping with its location.



SMC - the moat is a device for controlling movement of visitors and alludes to Sibu's riverine past.



SMC - urban lines in the plaza ...plaza aligns with the neighbouring lanes and streets. Its infill materials are often recycled from the construction process.



DNAhouse - beyond the gates, a transitional space is created by the long pool and landscape - the conference room bridges the pool and terminates the view.



Ironman forever - the transformation of the Forever building from staid to edgy in 4 months - given a new lease of life.



Garden wall - built with recycled roof tiles creating a dialogue between old and new.



Bjarne Mastenbroek's villa in Vals.



High line project converts a city eyesore into a public park.

JOURNAL ENTRY OF A DATUM FAN

- 4 JULY 2010

DATUM:KL takes place on the first weekend of July every year, it is touted as an international architectural design conference - bringing together local and foreign architects in a two-day conference in Kuala Lumpur. In recent years, this brain-child of PAM has grown to include the KL Design Forum (KLDF) and the ARCHIDEX. This year as usual, a large contingent from Sarawak attended the event.

Those attending do so for various reasons; for the lectures, for CPD points, for a chance to catch up with old friends and colleagues, as an office sponsored excursion and shopping trip. As a DATUM fan, I go for all of the above reasons; and what good value it was this year - there was a bumper crop of 12 speakers for DATUM plus another 4 for the KLDF. The theme this year is 'Second nature' - promising to look into architecture's role as a mediator between the technological world and the natural environment.

The KLDF is a preface to DATUM, this year Malaysian landscape architect Ng Sek San and graphic designer Chris Lee from Asylum in Singapore stood out from the rest. Though from distinctly different disciplines - they showed a commonality in a non conformist problem-solving design approach which evokes surprise at first glance and admiration a moment later.

The theme of the conference was more extensively explored during DATUM - the moderator Carson Chan had a difficult time linking the different approaches.

Day 1 opened with **Min from DNA** (Malaysia) who spoke about making use of existing elements found on site in their designs; to reduce the building's impact on the environment while the new can have a meaningful dialogue with the old. **Ko from K2LD** (Singapore) on the other hand, used materials and systems to reduce the building's perceived impact on the environment with some success. **Sou Fujimoto's** petite and poetic buildings is based on a 'primitive future'; re-interpreting the relationship of a building and its environment by melding architecture and nature (House N) or repetition of house forms as in 'Tokyo Apartments'. The Indonesian duo

from SUB have similarly minute buildings but chooses to mould them into the landscape to engage with nature in a more direct and conventional manner.

For many, the highlight of Day 2 was **Charles Renfro from Diller Scofidio + Renfro** (USA) but I felt his slick banter stole the limelight from his buildings (which were very good); built with compassion for the site and its history. His High Line project on the disused train tracks in the Manhattan meat packing district weaves its way through, over and under the congested cityscape; returning park land to the public. For me, the 'clever one' is **Bjarne Mastenbroek from SeArch** (The Netherlands). His 'tea house' is meant to be a model of energy efficiency while remaining completely transparent to its natural surroundings. It emphasises the value of natural resources and seeks to challenge human behaviour by raising awareness of both the power and vulnerability of nature throughout the building.

Lucy Bullivante (UK) and **Chris Chong from Tanjung Aru Pictures** provided a departure from the strictly architectural presentations - Lucy spoke about using buildings as a canvas for hi-tech interactive media while Chris used the façade of a multi-storey flat in Brickfield as his canvas for his film 'Block B' - painting multiple vignettes of tropical life from a solitary fixed point camera.

The highlighted speakers made more impact on me than others; some of the more familiar names did not step up to the mark. DATUM:KL is now a major regional event and should not be taken lightly; this year 2,500 people attended and chances are next year, there will be more. Therefore, I find it condescending for foreign architects to come to Malaysia and think that they can get away with a mediocre presentation or in some cases, showing more flash rather than substance.

But this is to be expected from a design forum; different people get different things out of it - therein lies the secret of its success; its range and diversity is the thing which keeps the people coming back. There are ways to still improve DATUM but that's the subject for another day.

DATUM-KL 2010 SPEAKERS

- 08 Wee Hii Min | Malaysia
- 10 Ko Shou Hee | Singapore
- 12 Kim Herforth Nielsen | Denmark
- 14 Alejandro Zaera-Polo | United Kingdom
- 16 Sou Fujimoto | Japan
- 18 Julien De Smedt | Belgium
- 20 Wiyoga Nurdiansyah & Muhammad Sagitha | Indonesia
- 22 Bjarne Mastenbroek | The Netherlands
- 24 Chris Chong Chan Fui | Malaysia
- 26 Duangrit Bunnag | Thailand
- 28 Lucy Bullivant | United Kingdom
- 30 Charles Renfro | USA

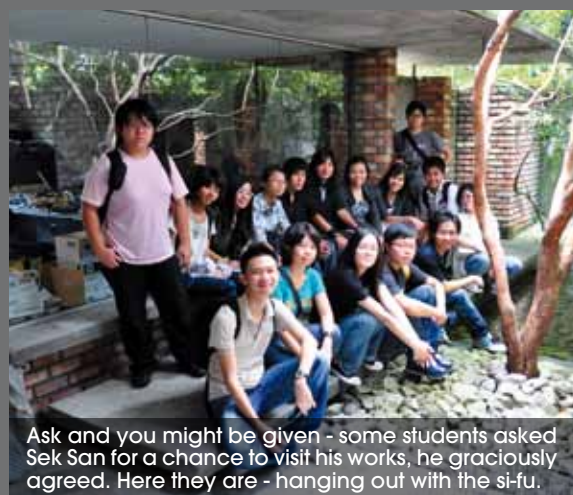

Ask and you might be given - some students asked Sek San for a chance to visit his works, he graciously agreed. Here they are - hanging out with the si-fu.



ARCHITECTURAL DIALOGUE : " Dude, where did you get that shirt? I love the florals ! "

Some delegates make use of DATUM to catch up with old friends.



Sou Fujimoto's House N



Exhibition of student work at DATUM.



Built strong to last



Engineered for strength

LYSAGHT® SMARTRUSS™ roof truss system's superior engineering is unrivalled in its quality, durability and safety. It is backed by BlueScope Lysaght's technologically advanced proprietary detailing software which models the geometry, designs the roof trusses and facilitates the manufacture of the roof truss system with precision. Manufactured from high strength long-life TRUECORE® steel, our system comes with a material warranty of up to 50 years*.

Fully designed and tested to Australian standards, the structural integrity of LYSAGHT® SMARTRUSS™ roof truss system is guaranteed through rigorous testing processes that include:

- ✓ Full Truss Test Rig
- ✓ Bearing test
- ✓ Top and bottom chord compression test
- ✓ Bottom chord tension test
- ✓ Web compression test
- ✓ Torsion test
- ✓ Restrained chords in bending test

LYSAGHT®. THERE IS NO EQUIVALENT

Copyright © 2010 by BlueScope Steel Limited. LYSAGHT® and TRUECORE® are registered trade marks and SMARTRUSS™ is a trade mark of BlueScope Steel Limited. *Warranty terms and conditions apply.

LYSAGHT

TrueCore®



BlueScope Lysaght (Sarawak) Sdn Bhd
Lot 610, Section 66,
Pending Industrial Area, Jalan Merbau,
93450 Kuching,
Sarawak, Malaysia.
Tel : 6082-333 621
Fax : 6082-483 486

www.bluescopelysaght.com.my



Roofing & Walling
Solutions



House Framing
Solutions



Structural
Solutions





PAM SARAWAK CHAPTER ANNUAL GENERAL MEETING

AGM underway.



Ar. Chew Chung Yee presiding over the election process.

The PAMSC Annual General Meeting was held at PAMSC centre on the 31st July 2010. The 2010 AGM minutes of meeting was read and discussed with the floor. The 2011 AGM Minutes of Meeting will be posted to members in our new website in due course.

With enough quorum, the election proceeded and this was presided by Ar. Chew Chung Yee.

As the posts were uncontested, the office bearers and committee members of the term 2009 - 2010 were reinstated for the term 2010 - 2011.

The 2010 - 2011 office bearers are as follows:

- | | |
|---|-------------------------|
| Ar. DESMOND KUEK (Chairman) | Ar. KEVIN WONG YII SING |
| Ar. MIKE BOON (Deputy Chairman) | Ar. TAN KIAT SOON |
| Ar. PETER WONG (Vice Chairman) | Ar. IVY JONG |
| Ar. STEPHEN MONG (Honorary Secretary) | Ar. CHAN KHENG LEONG |
| Ar. STEPHEN LIEW (Honorary Treasurer) | |
| Ar. NG CHEE WEE (Immediate Past Chairman) | |

- Co Opt Members:**
 Ar. LEE CHAI GUAN
 Ar. KELVIN PHUA
 Ar. WEE HII MIN
 Ar. DAVID ONG
 Ar. ARLENE CHEW

Committee Members:

- Ar. BONG JOON HIN
 Ar. KHO MENG KANG

PAMSC welcomes Ar. Arlene Chew as a new co-opt member for the term 2010 - 2011!



Serious business.....members reviewing the AGM report.



Coffee break.



Members exchanging views and news before the AGM.



Registration before the AGM.



2009 - 2010 PAMSC office bearers reinstated, uncontested for 2010 - 2011 term !



PAM committee with students and family members at the Habitat job-site in Batu Kawah.



PAM chairman conducting the ground breaking ceremony.

PAM AND HABITAT FOR HUMANITY

PAM and Habitat

On the 22nd of May 2010, several members of the present PAMSC committee; Desmond Kuek, Ng Chee Wee, Milke Boon, Kevin Wong, Ivy Jong, Min and Peggy took part in a Habitat for Humanity Build in Batu Kawah. Some of their family members and several university students from UPM and UTM joined them for the morning's excursion.

The objective was to raise awareness amongst architects about Habitat's activities and show how simple it is to 'give-back' to the community. Judging from the response of those who took part, it was hot work but it was very rewarding and they would like to volunteer again in the future.

The Site Report

Number of workers – 20 in total (generally un-skilled)
Number of child labourers – 4 (but their parents said ok)
Start time – 9:00 a.m. (after 7:30 a.m. breakfast at Dong Guan)
Weather – fine

Site activities

1. **Block laying** – from five feet high to roof beam level (9 feet). 3 batches of cement mortar were mixed by hand; 4 teams of two workers carried out block-laying supervised by Eric Yap the HfH construction manager.
2. **Construction of RC apron** – one team prepared the crusher base for the apron while another constructed the timber formwork around the perimeter of the house.
3. **Casting of RC apron** – concrete was mixed by hand (as the HfH concrete mixer was being repaired) and about 50% of the apron was cast that day.

Accidents and Injuries – Nil (blisters not counted)
RFI (Request For Information) – 1 nos. (from the kids – when can we come again?)
Overtime – nil.
Stop time – 1:00 p.m. The work day ended with a PAMSC sponsored luncheon at a coffee shop nearby.

Interesting facts about labouring on Habitat sites

Usually volunteers get to work alongside the home owners who are required to put in 400 hours of physical work towards the construction of their house as 'sweat equity'. The home-owner's children and relatives may contribute towards the fulfillment of the sweat equity. Eric (and more experienced volunteers) will teach volunteers who do not have construction experience. Children can volunteer but should be accompanied by a parent; there is an age limit and limit to the type of work they can carry out. Tools are provided as are gloves and water. Toilets are usually available.

For more info about volunteering at a job site, call Habitat office **082-242700** or email Min at weehilmin@gmail.com for accompanied excursions.



3 barrows of sand + one bag of cement + 8 buckets of water.



Easy does it....



Lisa and Sara laying blocks for the bedrooms.



Denise the pocket dynamo.



Behind bars.



Denise and her mom building formwork for the apron.



Ar. Chee Wee mixing it with the best.



Putrajaya Convention Centre, Malaysia

Exposed Roof System

Concealed Roof System

Roof Details

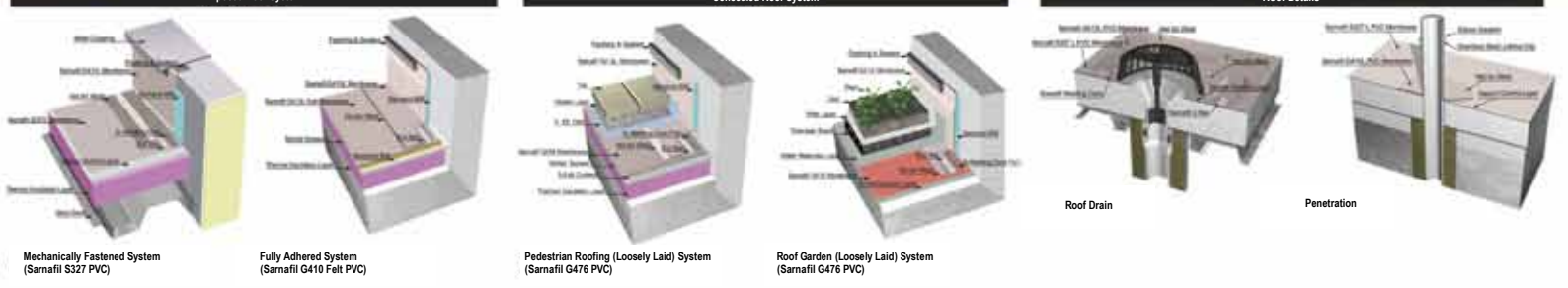

Mechanically Fastened System (Sarnafil S327 PVC)

Fully Adhered System (Sarnafil G410 Felt PVC)

Pedestrian Roofing (Loosely Laid) System (Sarnafil G476 PVC)

Roof Garden (Loosely Laid) System (Sarnafil G476 PVC)

Roof Drain

Penetration



Sports Center of South China Normal University, China



®

STRUCTURAL REPAIRS (EM) SDN. BHD.

(864112-M)

OUR TRADEMARK IS IN THE QUALITY OF OUR WORK

No 151, Lot 1498, 1st Floor, Hui Sing Commercial Centre,
 Stampin Road, 93350 Kuching, Sarawak.
 Tel: 082-463198 Fax: 082-570198
 Website: www.structuralrepairs.com.my
 Email: thebuildingdoctor@gmail.com

CHUA KOK KWANG
 Managing Director
 HP: 016-863 3232

We are the licensed supplier and local applicator for:

POLYVERS_POLYUREA
 WATER PROOFING SYSTEMS

ELMICH_VERSICELL
 ROOF DRAINAGE SYSTEM

SIKA_SARNAFIL
 ROOFING MEMBRANES



Putrajaya International Convention Centre
 85,000 m² of Sarnafil roofing membranes
 Main roof: 25,000 m², Garden terrace: 60,000 m²

QUICK TIPS ON VISITING THE SHANGHAI EXPO 2010



View of the Expo Site with China Pavilion in the background.



Overview of the Asian & Middle Eastern Pavilions Zone.



China Pavilion.



Overview of the Asian Pavilions Zone.



Denmark Pavilion.



UK Pavilion.

For those of you making a trip to the World Expo 2010 in Shanghai, here are some quick tips to get you going:

- 1) Go on weekdays to avoid the weekend crowd. Average crowd on weekday - 300,000, on weekends - over 400,000.
- 2) Wear a hat with a wide enough brim to cover your face. Wear sunglasses to cut off the glare.
- 3) Use plenty of sun-block.
- 4) Wear your most comfortable pair of shoes. Comfort is much more important than fashion in this case, as you will be walking and walking all day!
- 5) Water cannot be brought into the Expo site, but bring an empty bottle to fill up at the many water fountains around the Site. You can also buy mineral water at a reasonable RMB 3.00 everywhere.
- 6) You can bring food into the Expo Site - but why bother. There are lots of food outlets inside, some offering items you will normally have to queue at other locations to buy - e.g. the famous Nanxian Xiu Long Bao. Prices are also very reasonable.
- 7) When you get tired, find a nice place for a cup of coffee or drink to rest and relax.
- 8) Have a walk around the Site to see which are the pavilions you are interested in - then go back when the crowd gets thinner.
- 9) Waits at the most popular pavilions can be as long as 3 to 4 hours. Go to the less popular ones - you will find some gems.
- 10) Elevated walkways provide access to all the pavilions. Use these as they are well shaded - or walk under the elevated walkways which provide plenty of shade.
- 11) Free shuttle buses run along the main thoroughfares of the Expo Site. Use these if you want to go to the other end of the Site.
- 12) Toilets are clean and plentiful. Use the ones near the pavilions and not at the main entrance spine as these are less busy and are better maintained.
- 13) Crowds thin out after 4.00 p.m. You will have better chance getting into the popular pavilions in the evenings.
- 14) Outside of the pavilions are more interesting than the insides. Most displays inside the pavilions are just LCD displays or a few half-hearted exhibits. Most of the money and effort has been put on the outside.
- 15) Go to the Chile and New Zealand Pavilions. 2 of the best!
- 16) Must go to the Observation Deck at the Performing Arts Centre (The Flying Saucer). Great view of the Huangpu River and the Asian/Middle Eastern Side of the Expo Site.
- 17) To get into the China Pavilion - go to the Expo Entrance and queue at 5.00 a.m. Entrance passes will be given out at 7.00 a.m. and you can enter the Site at 9.00 a.m. (I skipped the China Pavilion, but some more determined travel mates managed to get in)
- 18) Allow at least 2 days at the Expo. 3 days would be optimum. Take your time. It is the atmosphere and the crowd that is the most memorable part of the Expo experience.
- 19) Check the performance programmes. Lots of interesting shows around the Expo site.
- 20) In most cases, the external design of the pavilions are more interesting than what's inside. If you can't get in because of the lines, don't fret - as you've probably seen the best part.

By Ar Ng Chee Wee



Just arrived. Check that important message.



What are we waiting for?



Briefing.



14 Product briefing at Z58.



Group photo.



Our bus. Home sweet home.

SHANGHAI GOOD EATS



Shanghai Street Food

Like other parts of China, Shanghai is not lacking in street foods as these are some of the staples of the local populace. With a hectic working life, even the most traditional Chinese families are finding it difficult to cook at home everyday, and the local street stall or corner shop provide that much needed pit stop to fill the stomach on the way to work or coming back after a long day.

As street food are meant to be cheap and stomach filling fare, they consist mostly of heavy doses of carbohydrates with a little bit of savouries and meats added for flavour. The most popular are buns, and there are endless varieties from steamed, sweet, savoury to deepfried or pan fried. Pan cakes are also very popular here. Like the Western bread which comes in endless varieties from just a few basic ingredients, the Chinese are also quite adept at turning the humble flour and egg into delicious tummy fillers.

Whatever your taste, you should be able to find something here which suits your tummy. The only problem is to have enough room to fit everything in !



Shanghai 2010 - First Breakfast

In order to save time, we took the red eye flight to Shanghai from Kuala Lumpur. When we arrived it was only 7:00 a.m. All the local businesses were still closed. As the in-flight service on MAS was a bit lacking, most of us were feeling quite famished. We ended up in a hotel near the airport for the buffet breakfast.

The place was a typical state-run hotel mainly for the local business crowd. There was quite a large selection of breakfast items, though the quality was a bit dubious. I decided to stick with the simpler fare, and most of them were not bad - especially the bacon !



Shanghai World Expo 2010 - Expo Food

Though the food scene in China remains mostly homegrown and Chinese, foreign food culture is slowly creeping into the country. McDonald's famously opened their first Chinese outlet in Shenzhen back in 1990, and since then many others have followed in their footsteps. Nowadays you will find endless Western fast food outlets and restaurants including high-end fine-dining at the major cities.

I was quite intrigued by a restaurant at the Expo - C. Straits Café, which is a homegrown chain of Western cafés making quite good inroads in China. They have countless outlets in China, and is even planning to expanding overseas. China is repackaging Western food and re-exporting it back ! Watch out - McDonald's and KFC.

The interior of the café is quite nice and modern. There are some oriental touches here and there, but otherwise it is quite "International" in design profile.

I ordered the Steak Set Lunch which came with coffee, a soup, salad and sirloin steak. I am happy to say the coffee was very good ! The mushroom soup was quite obviously batch produced in a central kitchen, maybe even from a can. It was quite bland and watery. The salad looked very fresh, but the dressing was too light. The steak, surprisingly, was quite good. Tender and cooked to the correct doneness that I had ordered. Unfortunately the accompanying sauce was not the best quality and was a bit too salty.

I must say the food standard was similar to other Western chain restaurants I have tried overseas. Perhaps they had used them as a model for their operation. If they can bring the food standard up a few notches and maintain the pricing structure, then they have a potent formula to compete with the World. The lunch bill came to RMB 98, which was quite reasonable.



By Ar Ng Chee Wee



Shanghai themed food !



POST SHANGHAI NITE

Shanghai Nite was organised as a get together for the participants of the trip to Shanghai Expo between 27th May to 2nd June 2010 to present slide shows and photo sharing for those who went as well as for non participants of the trip. It was held at PAMSC Secretariate Kuching on the 16th July 2010. 30 members and their spouses enjoyed an evening of Shanghai themed food and sharing of their Shanghai trip experience.



Chairman giving welcome speech.



Reminiscing Shanghai !



YK 榕钢集团
YKGI GROUP

A Leading Diversified Corporation Creating & Delivering Excellent Value



sewerage



seaside



meltshop



warehouse



school



NEO MATT
네오매트

Improved:

- Weather Resistance
- Formability
- Flexibility
- Scratch Resistance
- Water Permeability
- Chemical Resistance



Lot 712 Block 7 Demak Laut Industrial Park, 93050 Kuching Sarawak Malaysia

Tel: +6082 433888 Fax: +6082 433833

Website : <http://www.ykgi.com.my> E-Mail : ykgi@ykgi.com.my



ELMICH LANDSCAPE ROOF



GREEN WALL



EXTENSIVE GREEN ROOF



SUB-SURFACE DRAINAGE



STORMWATER MANAGEMENT



GRASS & GRAVEL PAVER



UNDER-SCREED DRAINAGE

ELMICH provides these products:

LANDSCAPE ROOF (a.k.a INTENSIVE GREEN ROOF)

VersiCell® sub-soil drainage modules

EXTENSIVE GREEN ROOF

VersiDrain® 25P water retention & drainage trays

GREEN WALL

VGM™ vertical greening modules

SUB-SURFACE DRAINAGE

VersiCell® multi-purpose cellular drainage modules

STORMWATER MANAGEMENT

VersiTank® 250 & 550 general purpose percolation tanks

VersiTank® 840 & 880 general purpose percolation tanks

UNDER-SCREED DRAINAGE

VersiDrain® 6P under-screed drainage mat

GRASS & GRAVEL STABILIZATION

TurfPave® XD grass & gravel paver

SLOPE PROTECTION

VersiWeb® cellular confinement system

BEARER & PAVER SUPPORT

VersiJack® height & slope adjustable pedestal

VersiPave GP® height adjustable paver support

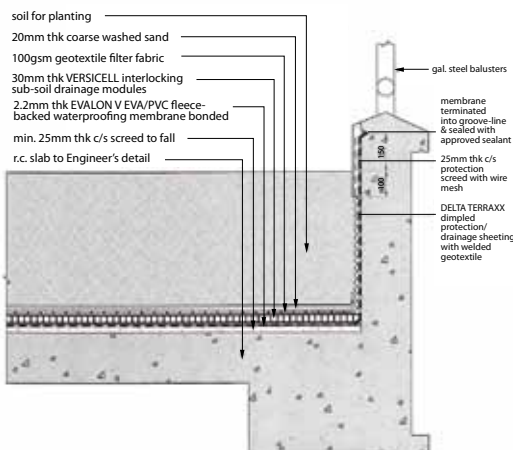

VERSI PAVE



ROOTGUARD ROOT BEARER



VERSIJACK



SLOPE PROTECTION



THE BUILDING DOCTOR

STRUCTURAL REPAIRS (EM) SDN. BHD. (864112-M)

OUR TRADEMARK IS IN THE QUALITY OF OUR WORK

No 151, Lot 1498, 1st Floor, Hui Sing Commercial Centre,
Stampin Road, 93350 Kuching, Sarawak.
Tel: 082-463198 Fax: 082-570198
Website: www.structuralrepairs.com.my
Email: thebuildingdoctor@gmail.com

CHUA KOK KWANG
Managing Director
HP: 016-863 3232

We are the licensed supplier and local applicator for:

POLYVERS_POLYUREA
WATER PROOFING SYSTEMS

ELMICH_VERSICELL
ROOF DRAINAGE SYSTEM

SIKA_SARNAFIL
ROOFING MEMBRANES



Putrajaya International Convention Centre
85,000 m² of Sarnafil roofing membranes
Main roof: 25,000 m², Garden terrace: 60,000 m²



NGU SHAN YING
(SMK Jalan Arang - 13 years old)



BRENDA TAY SIAW JOO
(Lodge Secondary School - 14 years old)



AHMAD ISKANDAR BIN OMAR ALI
(SMK Demak Baru - 14 years old)

DRAWING CONTEST FOR SECONDARY SCHOOL

PAMSC Sub Committee for Conservation and Sustainable Design chaired by Ar. Ng Chee Wee, with the support of ICI Paints Malaysia organised an Art Competition for secondary students from February to May 2010. The theme of the competition is " Built Heritage of Sarawak ".

This competition is aimed at increasing the student's awareness of the richness and significant of our built heritage.

The competition was divided into 2 categories:

CATEGORY A: For Senior Secondary (Age 16 to 19 years old)

CATEGORY B: For Junior Secondary (Age 13 to 15 years old)

At the closing of the competition on the 31st May 2010, 16 entries were submitted for Category A and 15 entries for Category B.

A judging for the entries will be arranged to pick the winners.

Here are samples of some of the entries received.



IKA SULASIH (Kolej Datu Patinggi Abang Hj Abillah - 15 years old)



AMELIA TAN SWAN YI
(Chung Hua Middle School No.4 - 14 years old)



YONG MEI TENG
(SMK Jalan Arang - 17 years old)



ALFRED YAP ZHEN YONG
(SMK Jalan Arang - 15 years old)



EDWIN HO (SMK St. Thomas - 15 years old)



TEO WEN XIN
(Lodge National Secondary School - 14 years old)



KHO HUI CHERN
(SMK Sg Maong - 16 years old)



JOCLEYN YAP KUI LING
(SMK Arang Road - 17 years old)



KONG CHIN HUI
(Chung Hua Middle School No.4 - 19 years old)

COMING SEMINARS AT PAMSC CENTRE

Date	CPD points	Seminars	Speakers
28/08/10	2 pt	EcoTowns for Asia - Application of Sustainable Technology	Mr. Joe Eades
25/09/10	2 pt	Marketings for Architects	ICI speakers
23/10/10	2 pt	Architects & Landscape Architects working together	Ar. Michael Lip
27/11/10	2 pt	Comparison between Sole Proprietor vs partnership vs Sdn Bhd and Relevant Tax Issues in the Related Business Set Up	Ms Lynn Leong, Mr Ng Kim Cheong
To be advised	4 pt	Designing for Fire Safety - Part 1, 2, 3 & 4	Ar. Chong Lee Siong

Points in Summary

1. The new Architects (scale of minimum fees) Rules 2010 is gazetted to come into force with effect from 1st March 2010. Circular to inform all architects will be sent out and copies of the new rules can also be purchased at the cost of RM20.00 a copy. LAM will also write to all Government Agencies.
2. LAM to act as stakeholder for Architect's fee. Ministry of Works have approved the proposal, PAM have been requested to look into the mechanism for implementation.
3. **Clerk Of Works**
New revised salary scheme for Government scale but only for new projects that are signed after this new revised scale of salary. Just approved, circular will be sent to all Government agencies. Revised scale is almost double of that for the old scale.
4. **Appointment of Foreign Consultants for Government Projects**
LAM is not happy that the government is not promoting local architects and are impressing on the government to hold local competitions among local architects for 'prestigious' government projects. However if the project is fully foreign funded then it would be unreasonable to insist on local only.
5. **'Design and Build' projects**
Cases of architects not getting paid and turning to government for payment. The LAM's view is that under such contracts the Government have no contract with consultants and hence cannot pay consultants. Architects involved should be more alert. Board to write to Treasury in future the design and build contractors must show proof of MOA with consultants and proof of payment during the course of work.
6. **Supervision by Professional Architects**
To be done by a qualified person and must be for the whole duration of the project. That is why the Board wants to put the clerk of works under the Architects Act and registration so that a bench mark and quality control can be set for clerk of works.
7. **PAMSC brought up the following issues**
 - 7.1 **Speeding up the process of building plan approval.**
Recommending to local authorities that architectural drawings, like the engineers drawings, will be submitted for record provided that the drawings are endorsed by Bomba and Lands & Survey and construction may proceed immediately since the submitting person is always liable. LAM said that in view with the current Government Transformation Programme the West Malaysian counterpart are also pushing for the same.
 - 7.2 **Upgrading of Bachelor degree to Masters degree for certain Institution**
The Board is fully aware of the current situation and is in the process of writing to all the LAM recognized schools to ask them for confirmation that the change in the conferring of the masters degree does not change the course structure that is recognized by the LAM.

On this note LAM also highlighted the issue of twinning courses. If the initial Part 1 of the architecture course is not done in a school recognized by LAM and even though the student may have completed the bachelor or masters degree at a recognized overseas institution, LAM will still not recognize the qualification because of the initial part of the training.
 - 7.3 **Non resident submitting person**
Local authority to check if such submitting person exist still and any errant act committed by any submitting persons must be reported to LAM immediately. The local authorities do not have the power to deter them from submitting or to suspend them. Local authorities may have the opinion that LAM takes 2 to 3 years to deal with any reported case. This is not the case now, inquiry committee can be set up quickly to deal with any specific complaints.
8. Meeting adjourned at 12:10 pm.

PAMSC rep: Ar. Chiew Chung Yee
We warmly extend our appreciation to Ar. Chiew Chung Yee for his time and effort to represent PAMSC at LAM.

JohnsonSuisse

Bathroom solutions



M-Class®

The Excellence of M-Class

Ceramic
Roof Tile
with

Interlocking
System

Established Since 1997



Sistem Interlocking / Interlocking System

Mencegah bergeser dan bocor.
Prevents movement and leakage.



Tanggul Air / Water Resistant
Mencegah tampias dan rembesan air.
Prevent splash and water penetration.



Dilapisi Glazur / Glazed
Air tidak merembes, anti lumut dan warna terjaga.
Resistant to water penetration, moss and color fading.



Sistem Pengepakan / Packing System
Mengurangi risiko retak dan pecah pada saat pengiriman.
Minimizes risk of cracking and breakage during transit.



CAMBRIDGE 30

Laminated Shingle

IKO Cambridge shingles are laminated to provide a remarkable dimensional thickness, not only for strength, durability and weather resistance, but also to create an extraordinarily beautiful look for your home. Cambridge is manufactured in a larger size with more exposure to create a high definition "shake" look for your roof. Its double layer construction, using an extra-heavy fiberglass mat and tough modified sealant, provides superior durability and wind resistance. All Cambridge shingles are surprisingly affordable and are the perfect choice to protect and beautify your home. Cambridge 30 Western shingles feature an angle cut design.

- Fiberglass asphalt shingles
- Laminated architectural design
- F.M. tested class "A" Fire Resistance Rating**
- Limited wind warranty coverage up to 60 mph (97 km/h)
- Limited 30-Year Warranty*
- 3 year IKO "Iron Clas" protection*



*See Limited Warranty for details.

**All IKO fiberglass shingles require an approved underlayment when applied on roofs with a slope less than 8/12. Class "A" Fire Resistance Rating is achieved only with the installation of an approved underlayment.

Note: Cambridge shingles available from Calgary and Sumas plants are designed with an angle cut.

Onduline

ROOFING MADE EASY

Good Heat / Thermal Insulation

One of the best thermal insulation.
Good Heat Insulation $\lambda = 0.098$ w/m.

Strong Sound Absorbency

Extremely effective against rainfall noises thus creating a unique living and working comfort in residential / commercial premises and improving productivity in farm buildings.

Waterproof

Waterproof is guaranteed 10 years in proper fixing instruction and normal usage conditions.

Light Weight

Only 6.4kg per sheet less purlin support needed.
(Length: 2000mm, Width: 950mm, Thickness: 3mm)

Strong

Withstands winds up to 120mph (192km/h) proving its suitability in hurricane and earthquake conditions.

Durable

Not subject to rust, corrosion and brittleness.

Asbestos Free

Onduline does not contain asbestos. Asbestos has been classified as a cancerous material in 1977 by the International Agency for the Research on Cancer. Many countries in the world have already adopted new regulations accordingly.

Cost Effective

Needs very little maintenance once the roof is installed according to our fixing instruction.

優越建材有限公司
ADVANCE BUILDING PRODUCTS SDN BHD

Vincent Ling

H/P: 013-365 5962

Kuching

SL 4, Lot 496, Jalan Muara Tuang
93250 Kuching, Sarawak
Malaysia.

H/P: 013-365 5962

Sibu No. 58, G/Flr, Jln. Sg. Antu 3,
Sg. Antu Industrial Estate 96000 Sibu,
Sarawak Malaysia.

Fax: 084-328 044

KL No. 4, Jalan Ara SD7/4B, Bandar
Sri Damansara 52200 KL, Malaysia.

Tel: 603-6277 6488

Fax: 603-6277 6489

Email: jerus_deco@yahoo.com



Courthouse by Tay Tze Yong.



Victor's shophouse.



Anything can be the subject of a sketch and can take place anytime (if you have paper ready).

SKETCHING WITH PURPOSE

– sketch-crawling in Kuching

Sketching is an important skill for designers as it enables the development our design ideas and for others to visualize them. In architecture, drawing and sketching are important tools of communication; to share ideas with clients; to argue the finer points of a concept with lecturers and to explain difficult details with contractors. But sketching can be more than an occupational tool; it can be a hobby to record a life time.

In order to create quality sketches, regular practice is more important than natural talent as it develops a fluency and confidence in the line work. It's a skill that anyone can pick up. I developed my skills from a book called – **"Drawing and Designing with Confidence: A Step-By-Step Guide"** – it taught me that there's a total of forty-five principles of good graphics. Though it is impossible for me to remember all the principles at once; by practicing spontaneous freehand sketching I became familiar with all the principles.

Recently, I became a member of the **Urban Sketchers**; a website where members sketch their 'piece of the world' and post their sketches on the website to share – so that people can see the world – "a sketch at a time". A few and I successfully started a "sketch crawl" group in Kuching – essentially the idea is to move from place to place within your town and draw what you see; spending short periods of time (from 30 minutes to an hour) at each spot. We then re-group at the end of the 'crawl' and share our sketches, to comment and encourage each other, and plan the next sketch crawl.

The idea of a 'crawl' comes from a 'pub-crawl' where participants would move from pub to pub and drink beer – when after a few pubs the participants would be 'crawling' rather than walking. Hence its name.

The main idea of on-location drawing is to capture the essence of the place, without necessarily labouring on the details at the time. It is good practice for everyone; student and architect alike. Everyone is encouraged to keep a journal and draw in it, so that you are be able to see your own progression through time and as a record of all the places you've been to.

Once in a few months, there would be a **"World Wide Sketch Crawl Day"** where everyone around the world would sketch their city, town or village, on that same particular day. All the sketches drawn on that day would then be shared on an official **'Urban Sketchers'** forum, where you'll get to see sketches by others in different places.

In other words it's a form of storytelling and I am glad to have formed this group of sketcher crawlers; with our own 'story' to tell, telling the world about our world here in Kuching.

By Azie – molsketchbook@blogspot.com



Colours added on-site.



Cynthia sketching at the museum gardens.



Museum sketch by Cynthia Yong.



Azie



Doing all your favourite things at the same time - sketching, talking, eating and being outdoors.



The combined results of a morning's sketching.



THREE AMIGOS

JS,FJ,AW

This is a story about three friends; whose lives were brought together by **architecture**, a love of travel, good food and even better friends. They were from different walks of life and different towns in Sarawak with a common quest - which was to pursue their studies in Architecture and to put their studies to the test. They are now working in Australia; perhaps to return one day.

INTERSECTION caught up with them in Kuching, Brisbane and Melbourne.

Felix Jee (FJ) studied in St. Joseph's school in Kuching; before obtaining his Diploma in Architecture at United College, Sibu (UCS) where he met Andy and James. He was a national & state swimmer and he believes the training has disciplined and motivated him until this day. He is presently working with PLUS Architecture in Melbourne.

James Sia (JS) is the smallest in stature but the biggest in personality and self belief; it is understood that he is currently the ping pong champion in his Australian office. He met the other two at UCS and later went on to study with them at University of Tasmania (UTAS). He is working with COX Rayner in Brisbane.

Andy Wong (AW) is the quiet and 'sensitive' one of the group, though one suspects that there is a tenacity which took him to Australia where he is working on gaining a deeper meaning of architecture while working at ML Design, Brisbane. His immediate goals are registration in the architectural profession and in matrimony.

This is their 'Postcard from the Edge'.



4th year - Theory & Design 2, group photo of our team members.



2007 - Final Year Project (Sarawak Aquatic Centre) a photo after my final presentation.



Design Event - 1-5th year combined group.



This is a model built based on the text of 'modification' by Macro Frascari.



4th year - Theory & Design 2, we are required to design & build a public sculpture based on a supporting theory in relation to a philosophical text provided by our lecturer.



Our student accommodation in UTAS.



FJ's housing scheme in Istanbul.

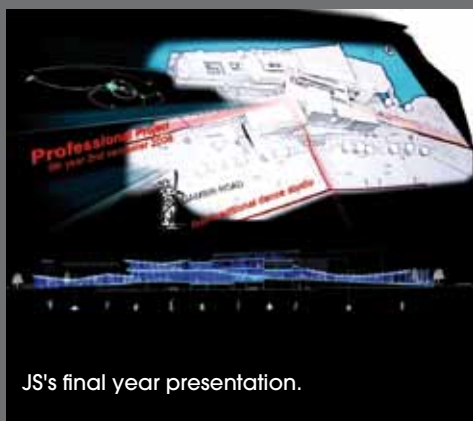
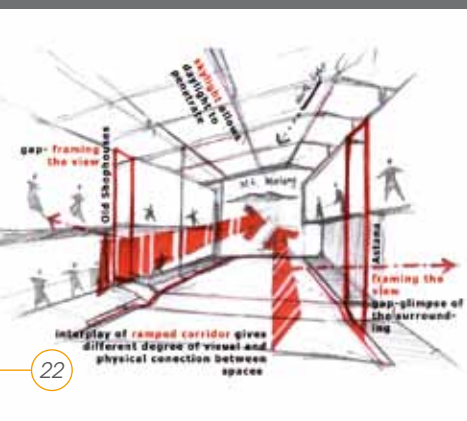

JS's final year presentation.



Townsville hospital expansion (COX Rayner).

CLAIMING AND PROCESSING EOT UNDER PAM CONTRACT 2006 WAS HELD ON THE 19TH JUNE 2010

Ar. Jerry Sum did a splendid job delivering what would have been a 'dry' subject matter into a lively and engaging topic to all who attended.



Speaker - Jerry Sum.



Participants at the seminar.

RECENT SEMINARS AT PAMSC



THREE SPEAKERS ON THE 18TH JULY 2010

- Part 1** - Ordering Disorder: Origins of Urban settlements in Sarawak
- Part 2** - Architecture, Identity and Cultural Sustainability in Contemporary Southeast Asian Cities
- Part 3** - 'Parabong': Some aspects of culture, power and the meaning of built forms in Sarawak 1841 - 1868

Speakers: **John Ting, Dr. David Benton and Dr. John Walker.**

John Ting

Dr David Benton

Dr John Walker



PAMSC SUB-COMMITTEE STRUCTURE 2009-2010

GOVERNMENT LIASON

Chairperson
Ar. Stephen Liew
Other Member
Ar. Bong Joon Hin

EVENTS

Chairperson
Ar. Mike Boon
Other Member
Ar. Ken Chan
Kelvin Phua (Graduate)
Ar. Tan Soon Kiat

PUBLICATION & INFORMATION

Chairperson
Ar. Ivy Jong
Other Member
Ar. Wee Hii Min (co-opt)
Ar. Stephen Mong (Adviser)

CONSERVATION & SUSTAINABLE DESIGN

Chairperson
Ar. Ng Chee Wee
Other Member
Ar. David Ong (co-opt)
Ar. Mike Boon (Adviser)

IT & EDUCATION

Chairperson
Ar. Kevin Wong

GRADUATES

Chairperson
Lee Chai Guan

DESIGN & LAYOUT

IMPACT DESIGN ASSOCIATES SDN BHD
Level 4, Unit 16 & 17,
DUBS Commercial Centre,
Jalan Petanak,
93100 Kuching, Sarawak.
Tel : 082-233 255
Fax: 082-232 422
www.impactdesign.com.my

PRINTER

WISMA PRINTING SDN BHD
Lot 1949 Section 66 KTLD Jalan Tekad
Pending Industrial Estate
93450 Kuching, Sarawak
P.O. Box A523 Kenyalang Park
93810 Kuching, Sarawak.
Tel : 082-338 131
Fax: 082-333 002
Email: wisma@po.jaring.my

PUBLISHER

PERTUBUHAN AKITEK MALAYSIA
(SARAWAK CHAPTER)
2nd Floor, Sub-Lot 56,
Jalan Wan Alwi,
Lot 7915 Queen's Court,
93350 Kuching, Sarawak.
Tel : 082-457 182
Fax: 082-451 180
E-mail: pamswk@streamyx.com



Certification No. 032-065

OUR PAINTS COME IN THOUSANDS OF COLOURS. BUT THE ONE WE'RE MOST INTERESTED IN IS GREEN.

Nature is the mother of all colours. We, at Nippon Paint, dedicate our best efforts to protect and preserve mother nature for the benefit of our future generations. We reduce energy consumption and minimise water disposal. We also developed ultra low VOC and energy saving products. As one of the leading paint manufacturers, we remain firmly committed to a better, brighter and cleaner future for the planet.

Contact us and let us show you more reasons why we are the paint experts.



The Paint Expert
www.nipponpaint.com.my



INDUSTRIAL | MARINE | AUTOMOTIVE | RESIDENTIAL | COMMERCIAL | PUBLIC DEVELOPMENTS